

## 型号说明

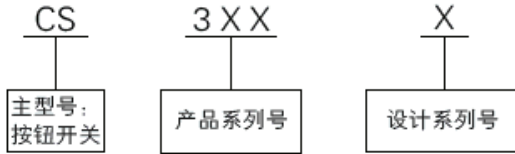

### ▲材料:

外壳: 铜镀镍/铬/不锈钢/仿金  
 底座: 酚醛模塑料(胶木)/PC  
 按钮: 铜镀镍/铬/不锈钢/仿金  
 触点: 银合金  
 接线端子: 铜镀银/镍

### ▲主要技术参数

额定电压/电流	介电强度	接触电阻	耐久性 (寿命)	环境温度
*	1500VAC50Hz/1min	≤0.04 Ω	>20000次	-40℃ - +85℃

可提供防护/防水等级IP54-IP68产品

CS330-3 按通 2P OFF-(ON)  
250VAC/5A

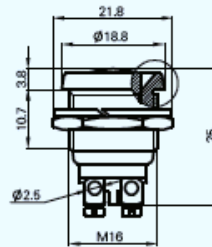

电路图

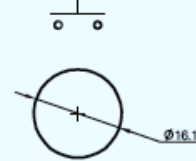

CS330/18-1C 按通 2P OFF-(ON)  
250VAC/5A

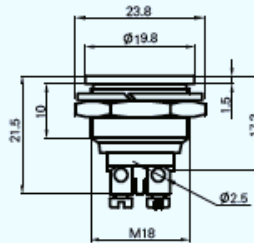

电路图

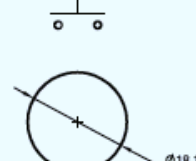

CS344C-IP4 按通 2P OFF-(ON)  
250VAC/5A 防水开关

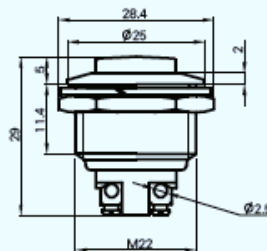

电路图

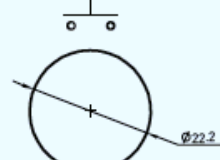

CS340 转换 6P ON-(ON)  
125VAC/1A 组合开关

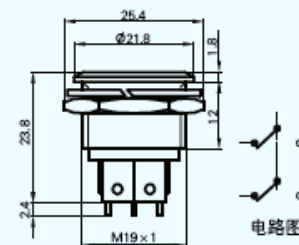

电路图

